



**DIVYA DEEP CONSTRUCTIONS**  
**DIVYA DEEP KUTEER-III**  
**EASTERN PART OF PLOT NO:756**

**PLOT AREA :522.08 Sq Yds**  
**:436.52 Sq mts**

	NORTH FACING	EAST FACING	AREA
1st floor	101	102	1566 SFT
2nd floor	201	202	1566 SFT
3rd floor	301	302	1566 SFT
4th floor	401	402	1566 SFT
5th floor	501	502	1566 SFT
<b>TOTAL : 1566x2=3132x(5)=15,660 SFT</b>			

**DIVYA DEEP CONSTRUCTIONS**  
**DIVYA DEEP KUTEER-IV**  
**WESTERN PART OF PLOT NO:756**

**PLOT AREA :478.33 Sq Yds**  
**:399.94 Sq mts**

	NORTH FACING	EAST FACING	AREA
1st floor	101	102	1584 SFT
2nd floor	201	202	1584 SFT
3rd floor	301	302	1584 SFT
4th floor	401	402	1584 SFT
5th floor	501	502	1584 SFT
<b>TOTAL : 1584x2=3168x(5)=15,840 SFT</b>			

**Promoters:**

**M/s. DIVYA DEEP CONSTRUCTIONS**  
**PLOT NO: 756**

**Project:**

**PROPOSED RESIDENTIAL FLATS**  
**AT UPPALBHAGAYATH**

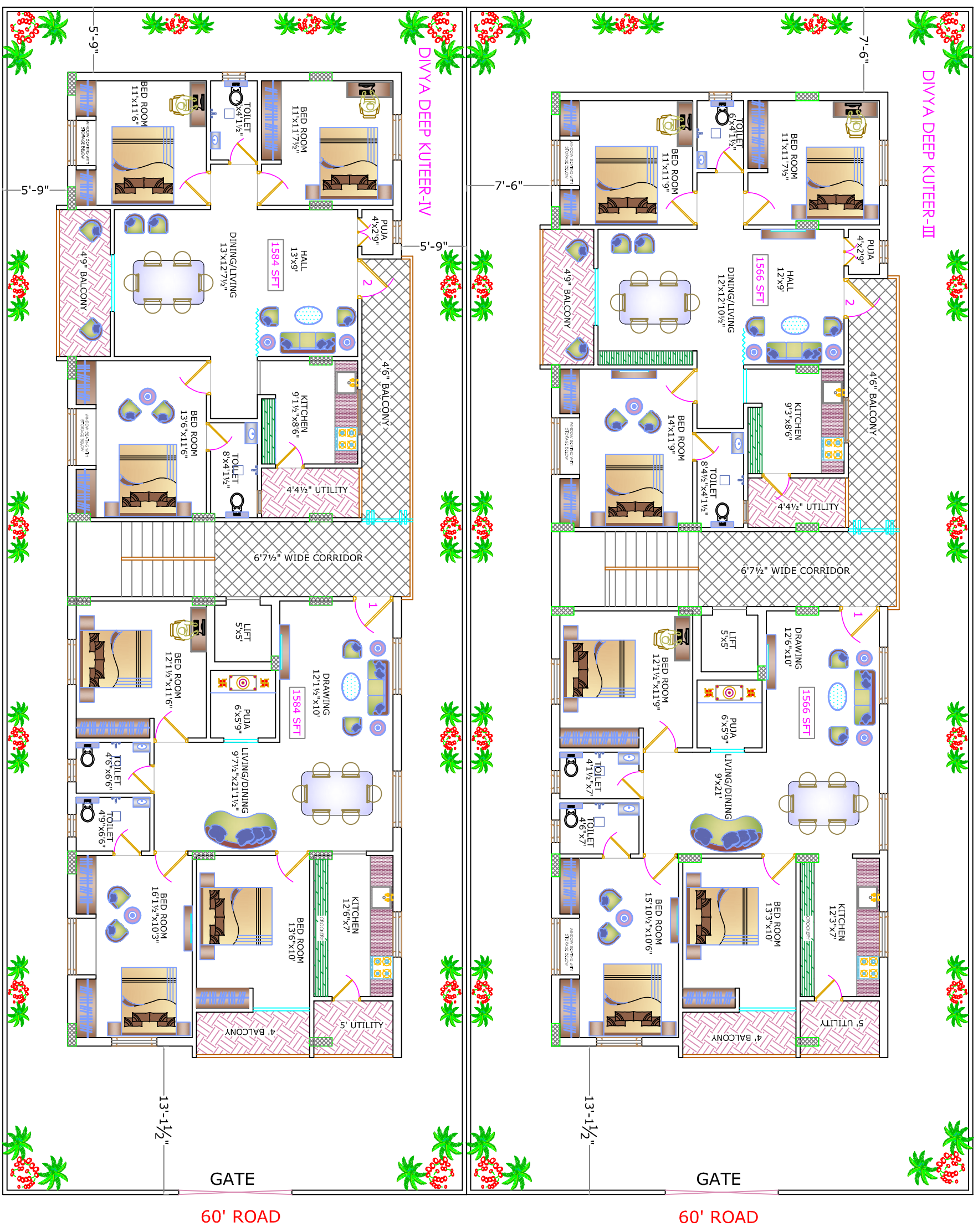

1 2 3 4 5 6 7 8 9 10 11 12

H G F E D C B A

10 11 12